

- Do not discard packaging until product has been successfully installed.
- SuperATV does not recommend keeping Windshield installed while transporting on an open air trailer. Remove or secure with straps.
- This item is not returnable if the protective film has been removed.
- Test fit to the cage to confirm fitment before removing film.

| Item | Description |
|------|-------------|
| A | Windshield |

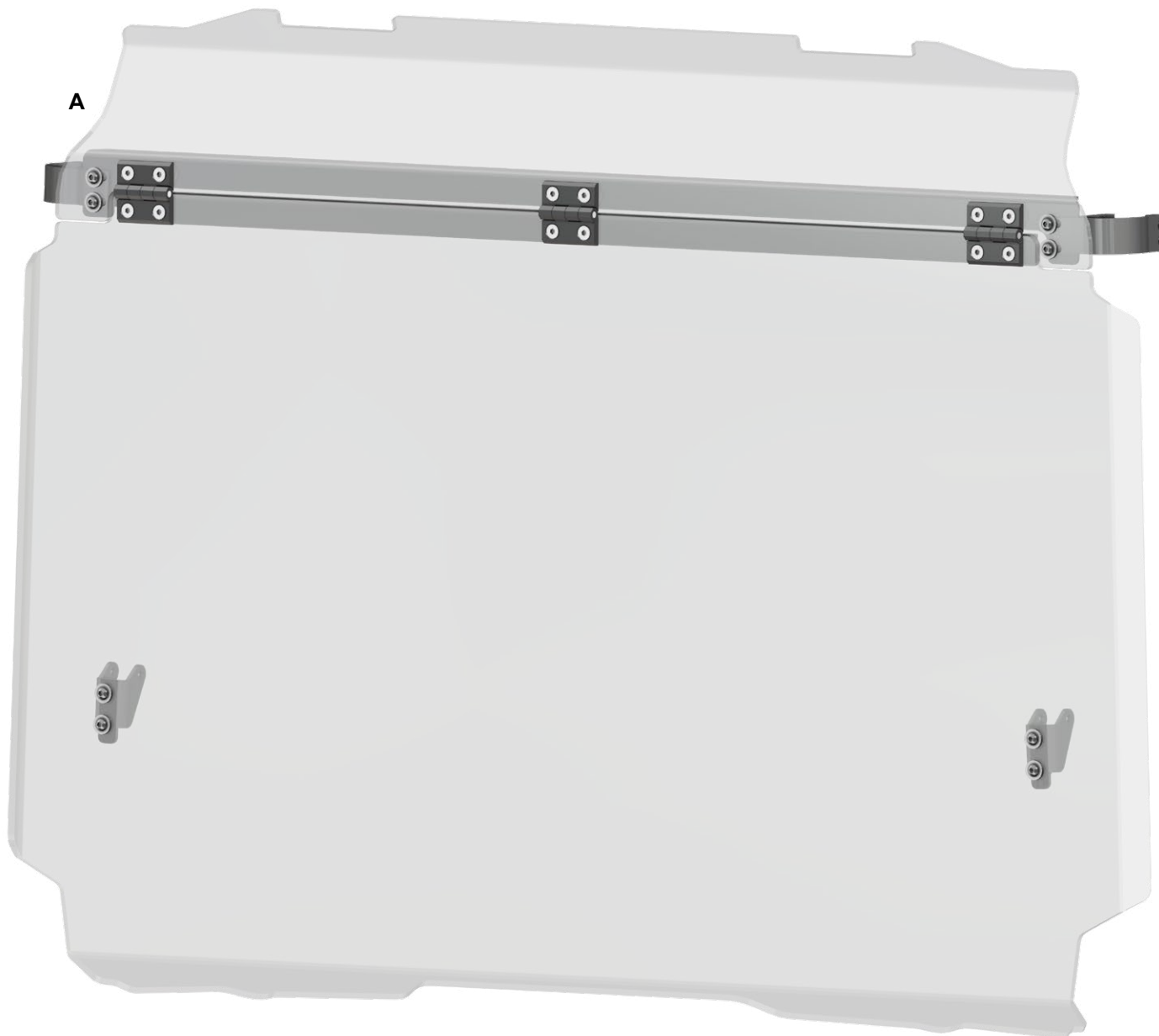

(kit contents continue on following page)

Need help with your installation?



sales@superatv.com



www.superatv.com



1-855-743-3427



8:00am - 8:00pm EST M-Th
8:00am - 7:00pm EST Friday
9:00am - 2:00pm EST Saturday

Read instructions and view illustrations before beginning.

*Thank You
For Choosing*

SUPERATV.COM[®]

(kit contents continued)

| Item | Description |
|------|----------------------------|
| B | Upper Actuator Bracket x 2 |
| C | Right Bracket |
| D | Left Bracket |

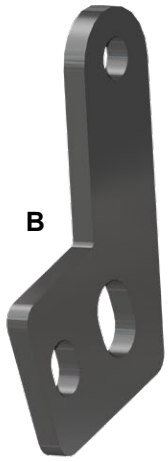

B

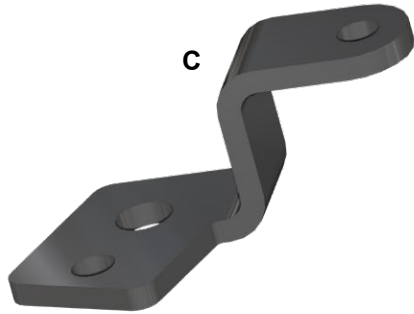

C

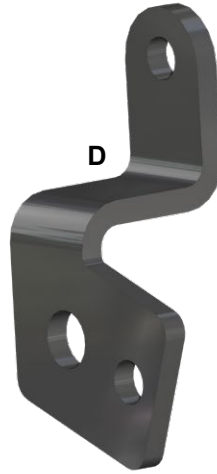

D



Actuator x 2

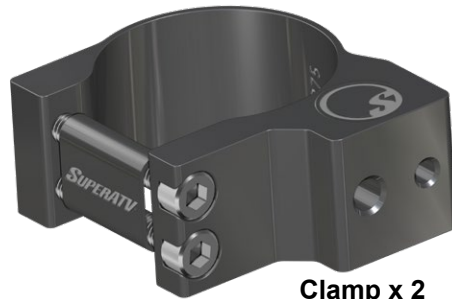

Clamp x 2

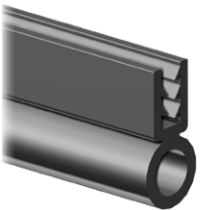

Seal

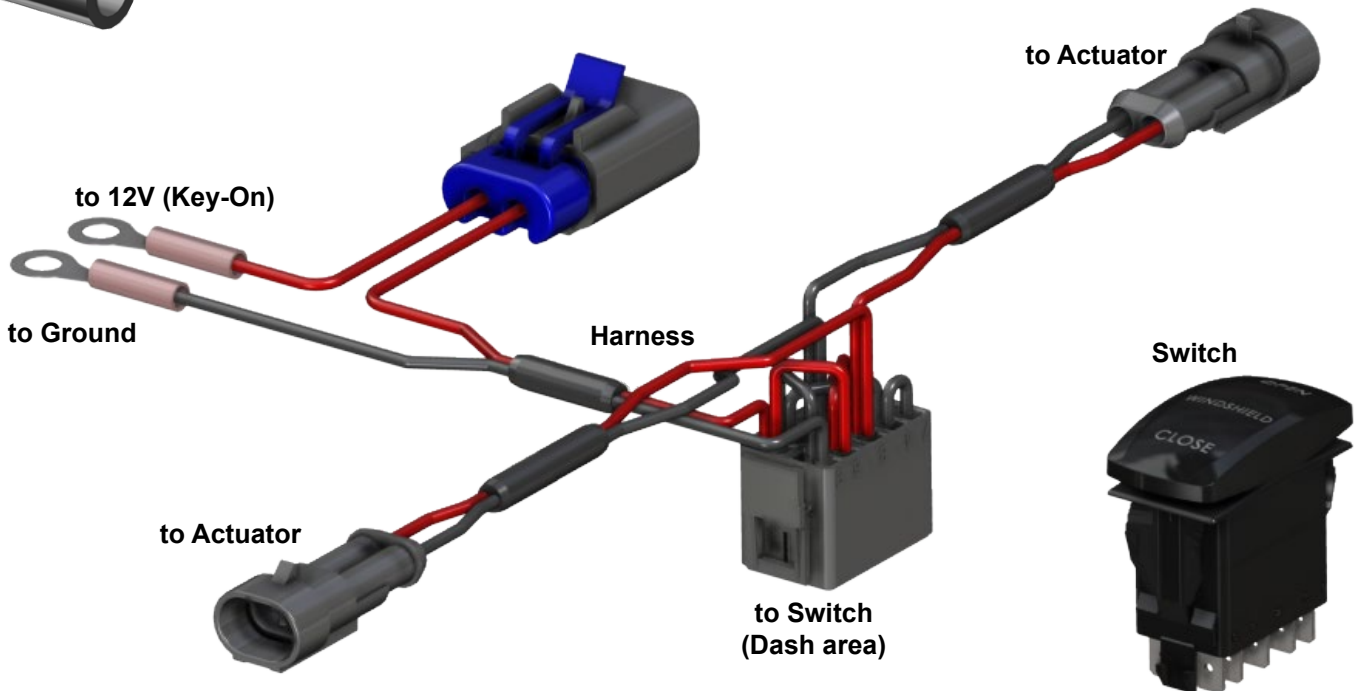

Windshield Cleaning:

- Do not use Rain-X®, Plexus® or any other protector, wax, or polish.
 - Do not use window cleaning fluids (Windex, 409, etc) or any solvents (gasoline, denatured alcohol, acetone, etc).
 - Never use abrasive cleaners, abrasive pads, or gritty cloths.
 - Do not use a windshield wiper blade or install a motorized windshield wiper
 - Never use razor blades, scrapers, squeegees, brushes, etc.
1. Thoroughly rinse Windshield to float off dirt and mud.
 2. Using a soft cloth, or microfiber cloth, clean Windshield with warm water and a gentle detergent. Baby shampoo or hand washing soap are recommended.
 3. To prevent water spots, use a chamois to blot Windshield dry.
-

- **Remove Cover and Bolts from all Clamps.**
- **Set aside.**

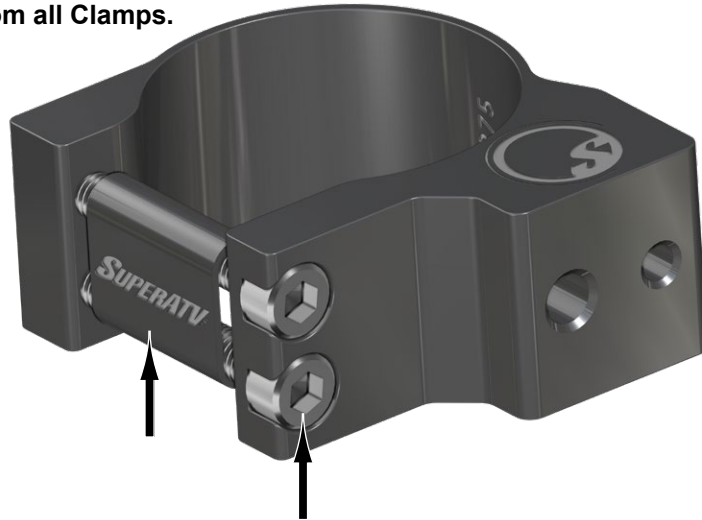

- **Install Seal to Windshield (A) in location shown.**

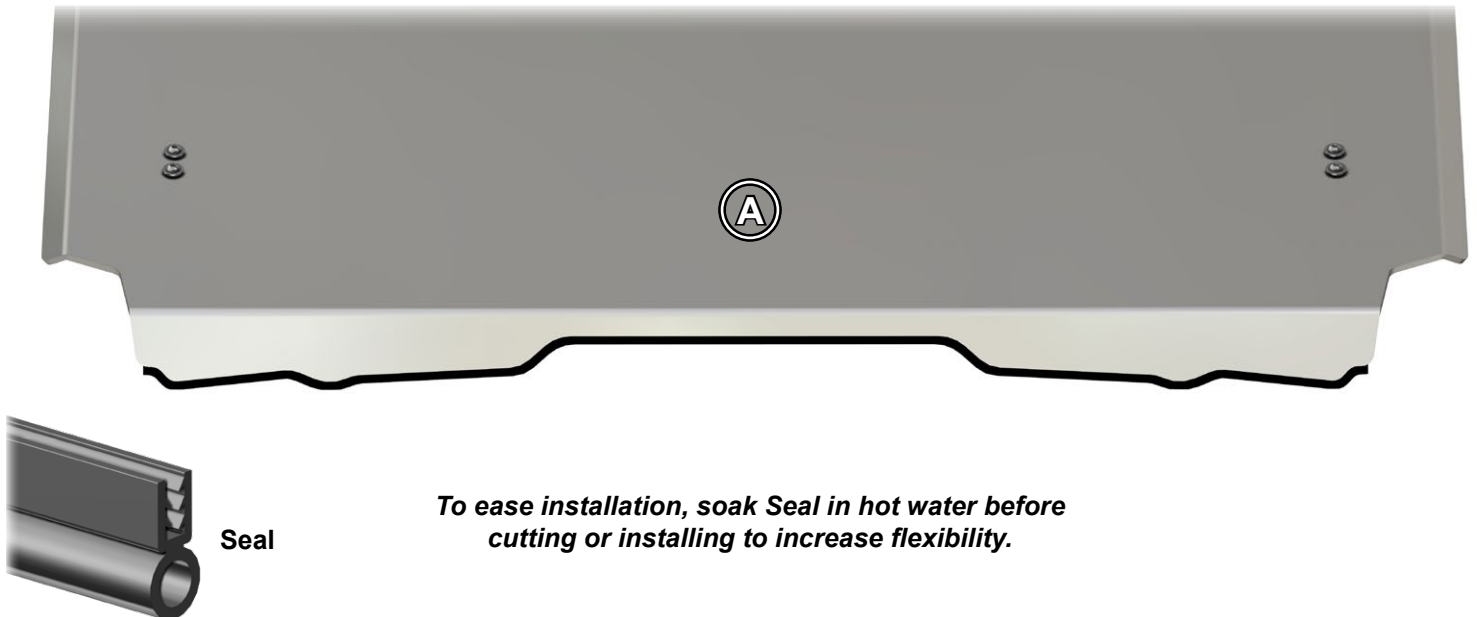

- Install Upper Actuator Bracket (B) and Left Bracket (D) to Clamp with hardware shown; do not tighten.
- Install Actuator to Brackets with hardware shown; tighten.

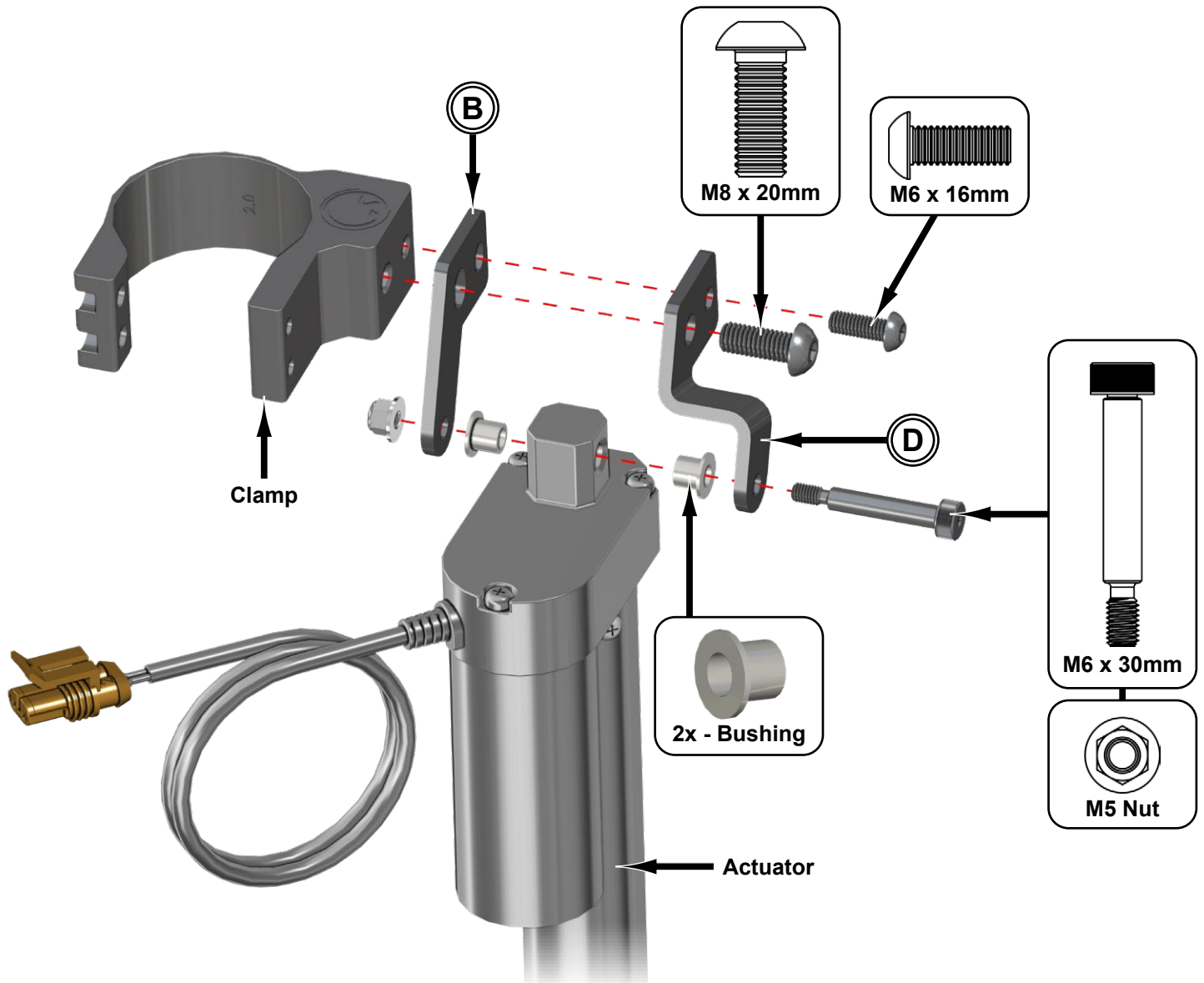

- Install Upper Actuator Bracket (B) and Right Bracket (C) to Clamp with hardware shown; do not tighten.
- Install Actuator to Brackets with hardware shown; tighten.

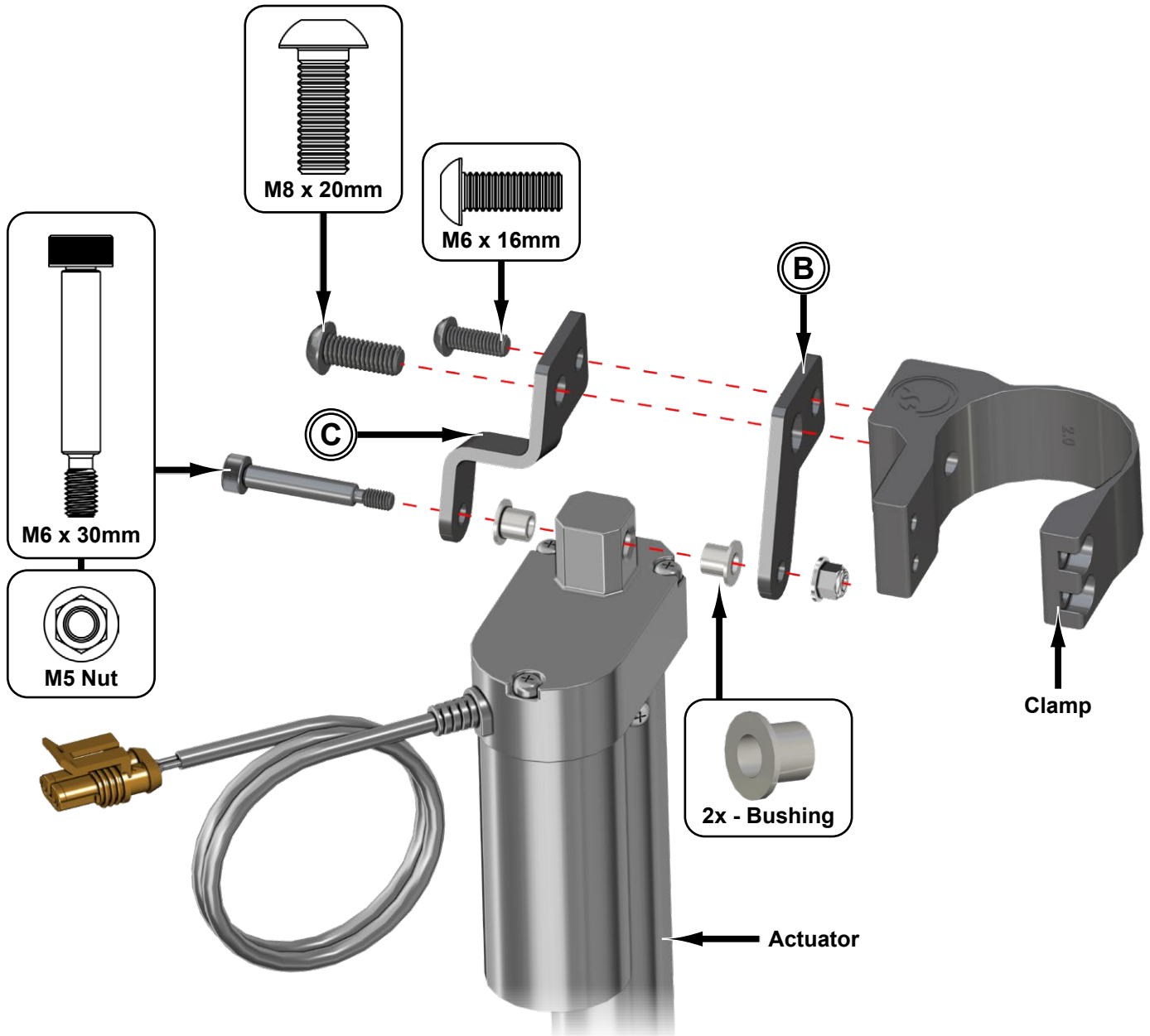

- Install Actuators to Cage; keep snug do not tighten.



(passenger)



(driver)

- Route each Actuator Harness towards storage compartment in Upper Dash (see page 10).



Upper section of Windshield will install *under* Cage.



- Place Windshield onto Cage.
- Secure Clamps with previously removed hardware.
- Align Windshield assembly to machine making sure that Seal, on Windshield, is in contact with Hood.
- Tighten all hardware and reinstall previously removed Covers to Clamps.



Seal to be in contact with Hood

- Secure Actuators to Windshield with hardware shown; tighten hardware.

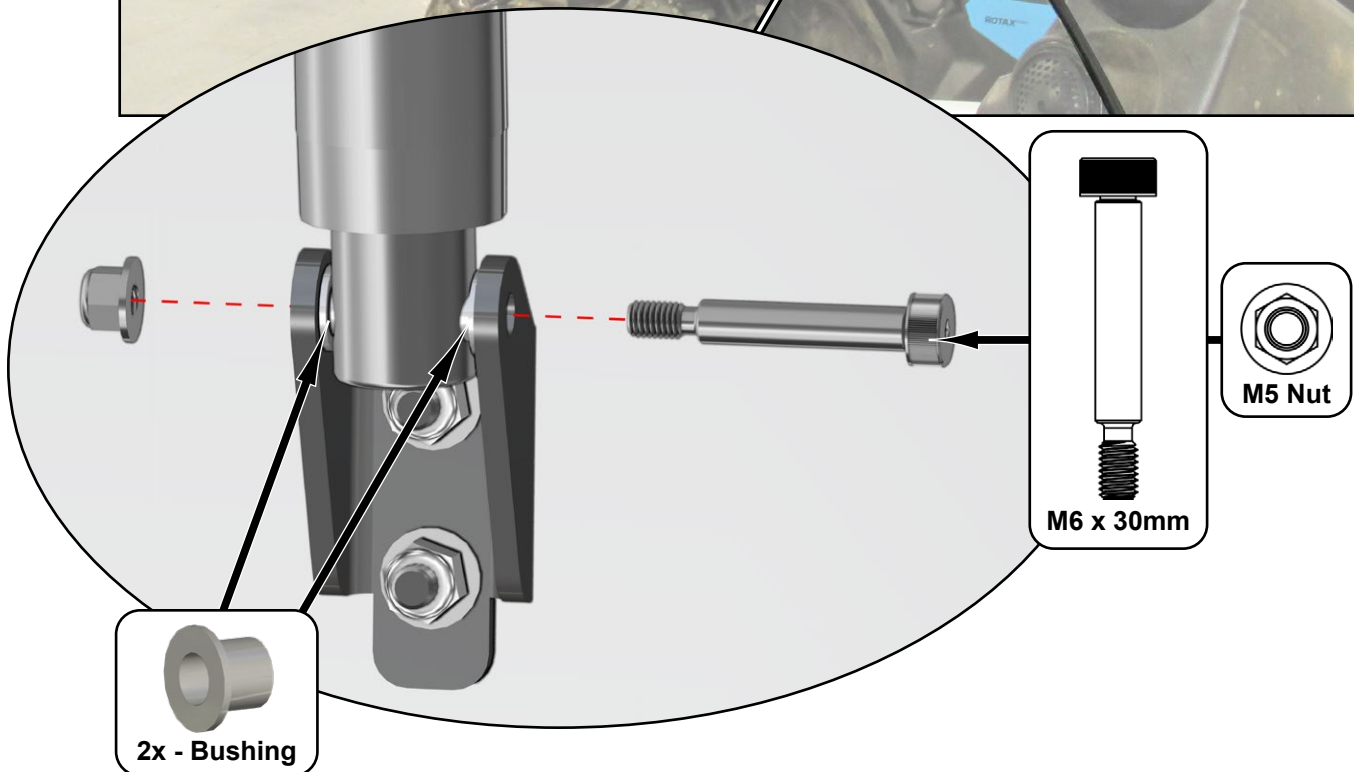

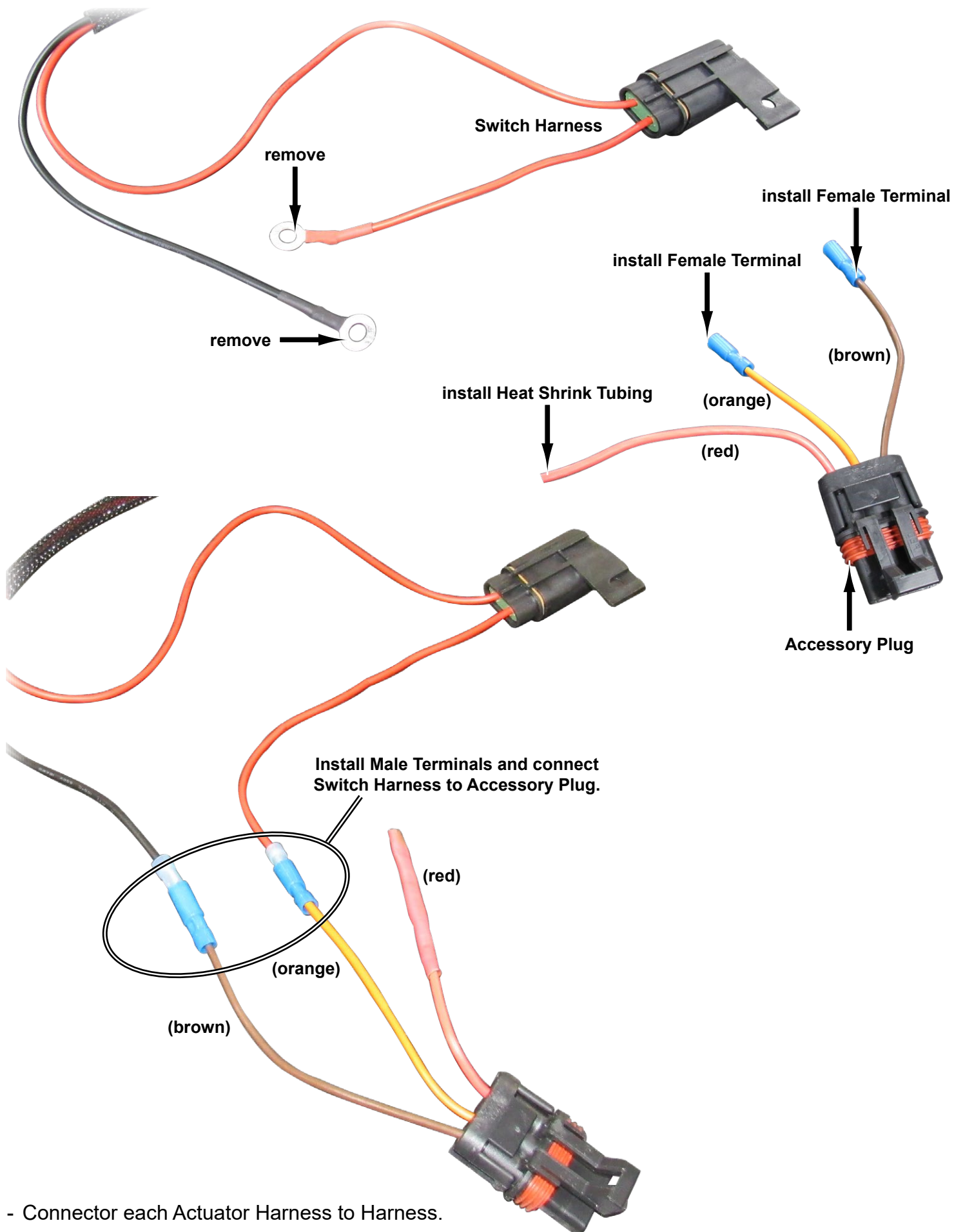

- Connector each Actuator Harness to Harness.



Before permanently mounting Switch, SuperATV recommends testing after all components have been installed.

Switch Mounting:

- User may install Switch in location different than shown.
- Verify that Harnesses will reach Switch before mounting.
- Remove stock Knockout or cut a new location.
- Connect wiring and secure Switch.

